

A WEST POINT

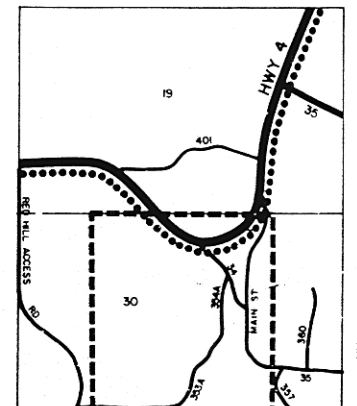

H VALLECITO

- 44 ANGELS RD
- 45 PARROTTS FERRY RD
- 46 CARSON ST
- 47 W VALLECITO
- 48 GARDEN LN
- 49 VALLECITO BYPASS RD

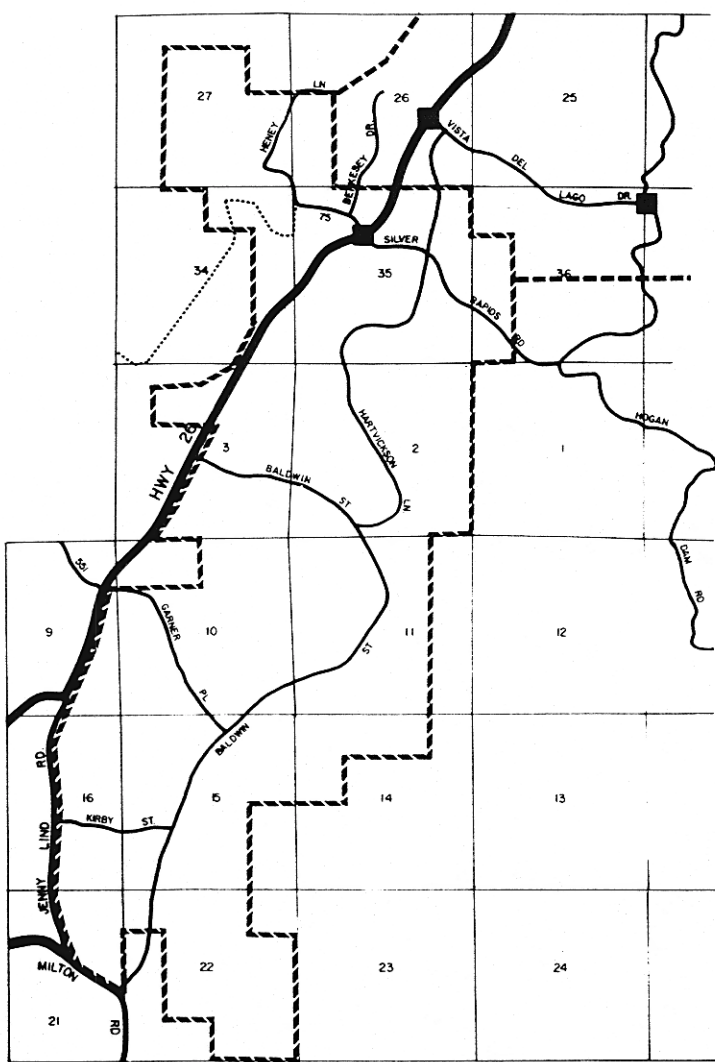

I RANCHO CALAVERAS/JENNY LIND

- 75 SILVER RAPIDS RD
- 55 OLIVE ORCHARD RD

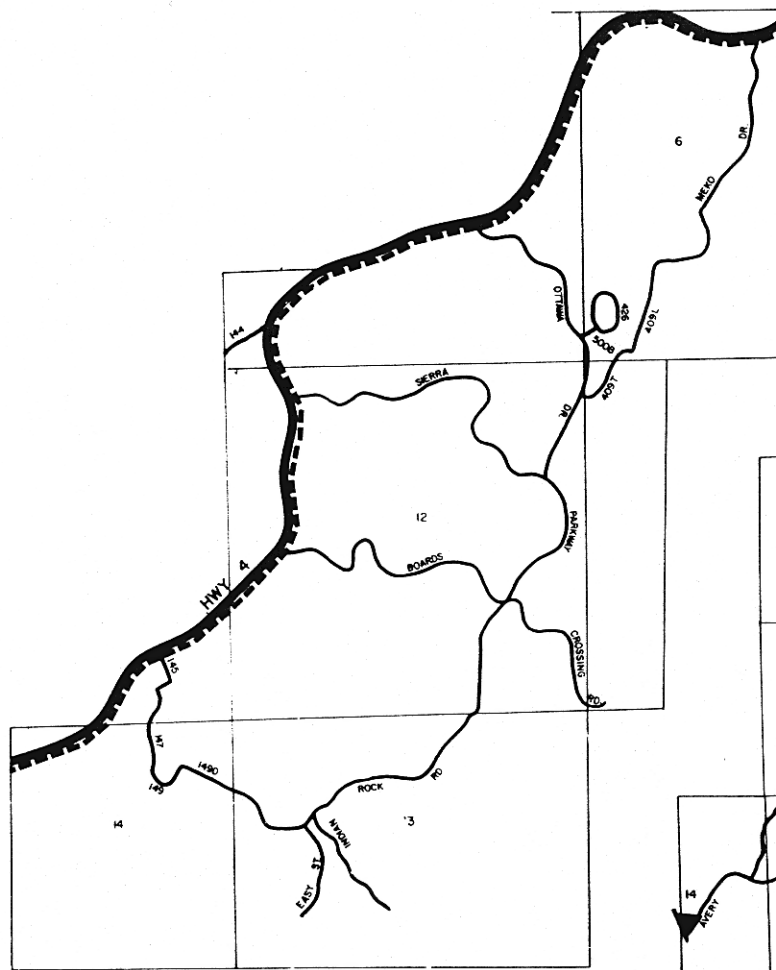

D DORRINGTON

- 44 SUMMIT LEVEL RD
- 45 BIG TREES VILLAGE DR
- 47 CHEYENNE WAY
- 48 WINDY RD
- 49 SOUX TR
- 491 SHOSHONE DR
- 491 HATCHET DR
- 426 BLACKFOOT CR
- 508 MENDOC LN

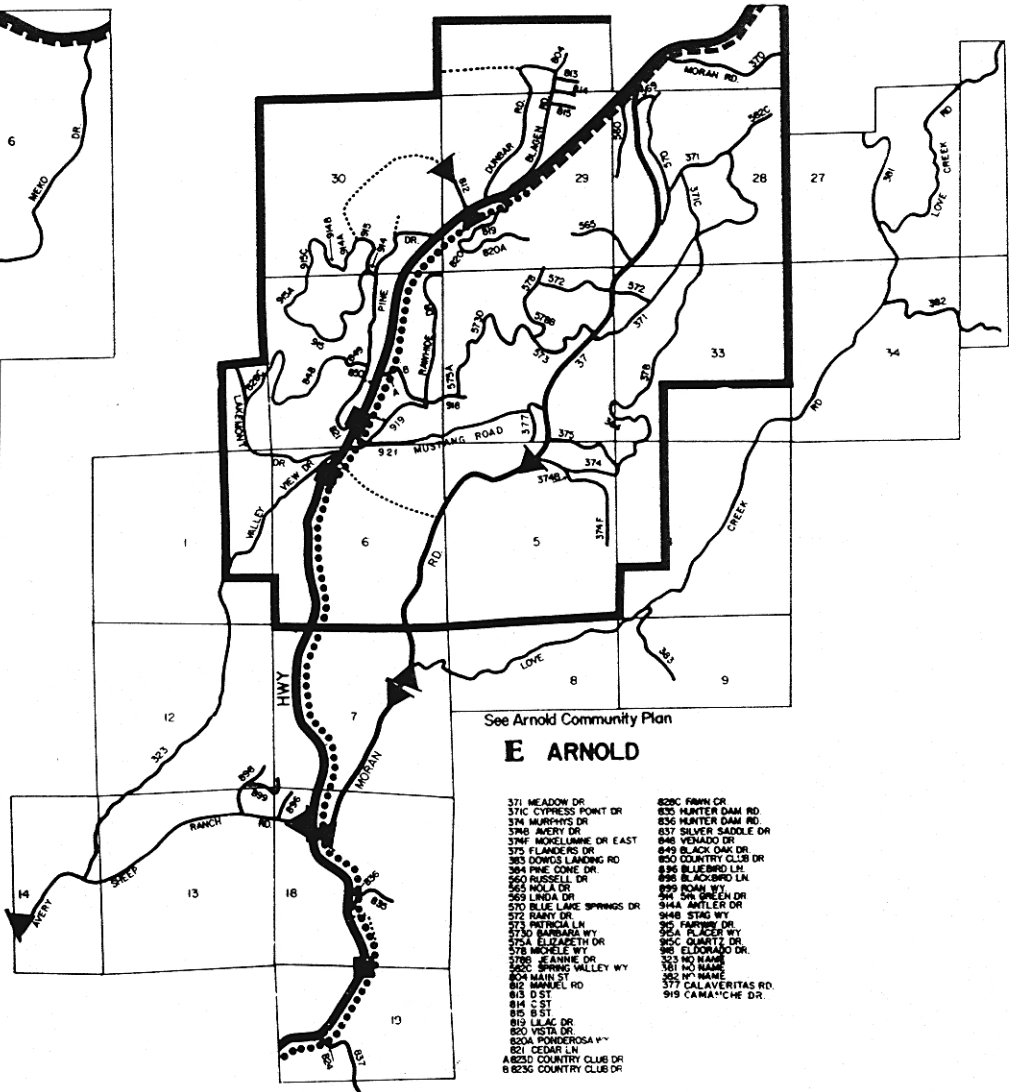

See Arnold Community Plan

E ARNOLD

- 371 MEADOW DR
- 371C CYPRESS POINT DR
- 374 MURPHY DR
- 376 AVERTY DR
- 377F MORELAND DR EAST
- 375 FLANDERS DR
- 383 DOWNS LANDING RD
- 384 PINE CONE DR
- 385 RUSSELL DR
- 385 HOLLA DR
- 389 LINDA DR
- 370 BLUE LAKE SPRINGS DR
- 372 RAINY DR
- 373 PATRICIA LN
- 374 BARNARD WY
- 375 ELIZABETH DR
- 378 MICHELLE WY
- 379 FANNING DR
- 380C SPRING VALLEY WY
- 384 MAIN ST
- 383 MANUEL RD
- 383 D ST
- 384 C ST
- 385 ST
- 389 LLAC DR
- 380 VISTA DR
- 380A POMEROSA W
- 381 CEDAR LN
- 382C COUNTRY CLUB DR
- 3823G COUNTRY CLUB DR
- 825C HUNTER DAM RD
- 825 HUNTER DAM RD
- 837 SILVER SADDLE DR
- 848 VENADO DR
- 849 BLACK DAW DR
- 850 COUNTRY CLUB DR
- 856 BLUEBIRD LN
- 858 BLACKBIRD LN
- 859 ROAM WY
- 864 SUEBEN DR
- 844A ANTLER DR
- 848 STAR WY
- 850 FAIRWAY DR
- 851 PULCES WY
- 852 QUARTZ DR
- 853 ELDRADO DR
- 854 PLACES WY
- 855 NO NAME
- 856 W NAME
- 857 CALAVERITAS RD
- 859 CAMA-CHE DR

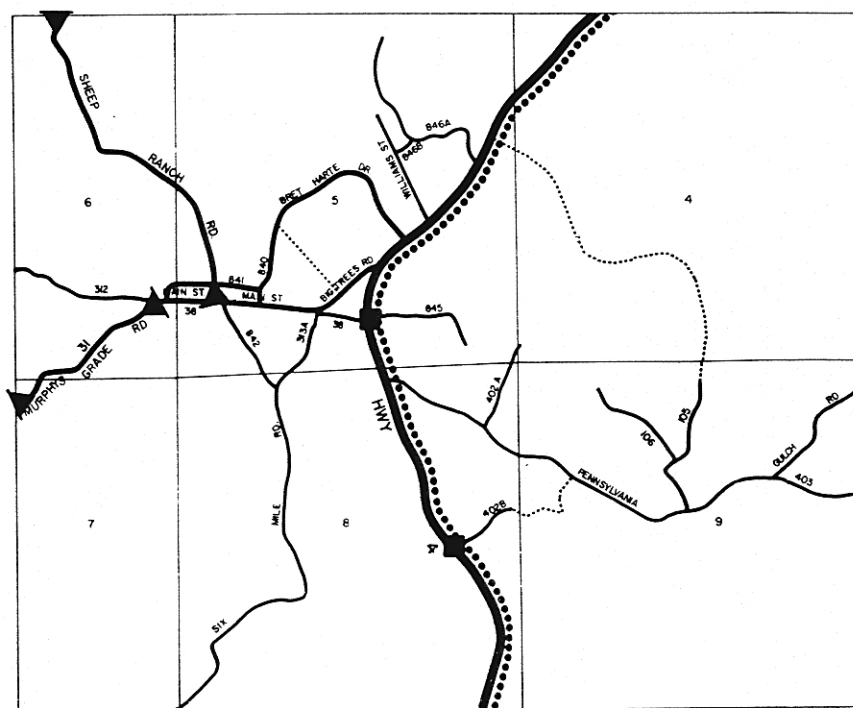

F MURPHYS

- 38 MAIN ST
- 105 ROARING CAMP RD
- 106 COYOTE DR
- 312 FRENCH GULCH RD
- 313A SCOTT ST
- 402A WOODLAND DR
- 402B ANNEY CT
- 403 SUNK RANCH RD
- 842 ALGIERS ST
- 843 BATHUR AVE
- 846A APPLE BLOSSOM DR
- 846B SHADY GROVE LN
- 840 SUPREY LN
- 841 CHURCH ST

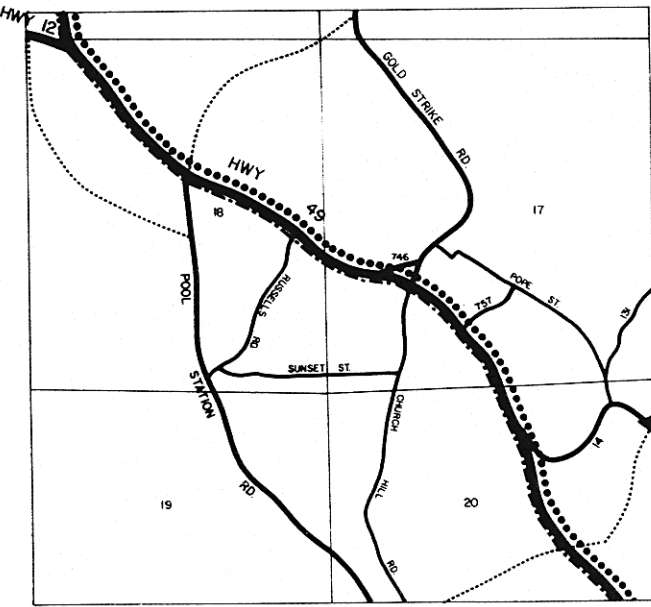

B SAN ANDREAS

- 44 MOUNTAIN RANCH RD
- 131 W MURRAY CREEK DR
- 737 GREAT HWY
- 746 COURT ST

See San Andreas Community Plan

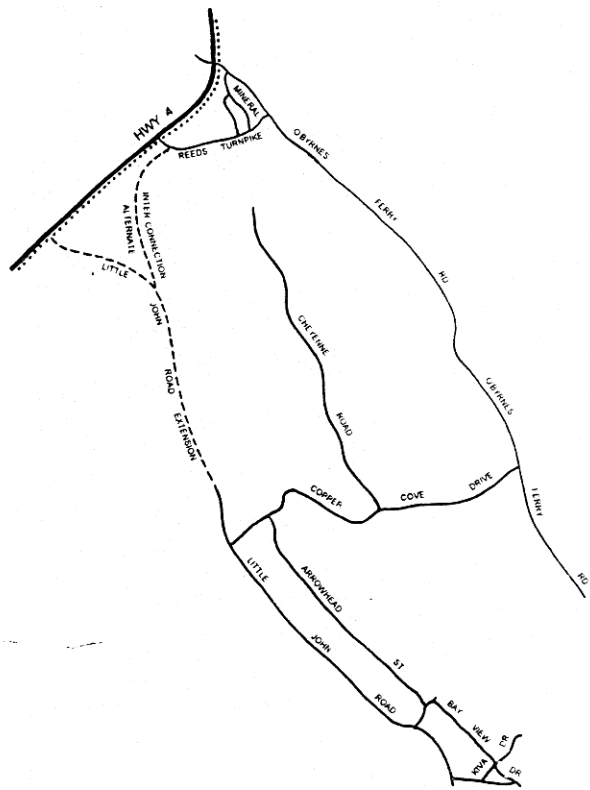

G COPPEROPOLIS

C COPPER COVE

Transportation Plan Map 4

Scheduled and Proposed Improvements

- ▶◀ Start/end of realignment or reconstruction
- Passing lane
- Turn lane

- Community Plan boundary
- - - Community Center boundary
- - - Special Plan boundary

Adopted December 9, 1996